

en 05-2014/08 50112701



- Configurable with screw terminals or insulation displacement technology
- Very good resistance against oil, cooling agents, lubricants, and chemicals
- Protection class IP 67

Dimensioned drawing

M8 connector, axial, 3-/4-pin
D M8A-3P-SK
D M8A-4P-SK

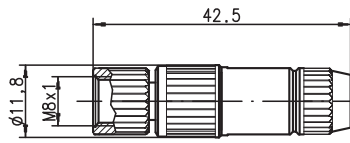

M12 connector, axial, 4-pin
KD 095-4A

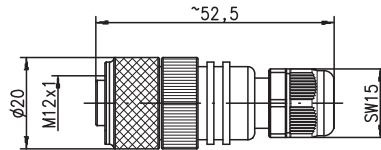

M12 connector, angular, 4-pin
KD 095-4

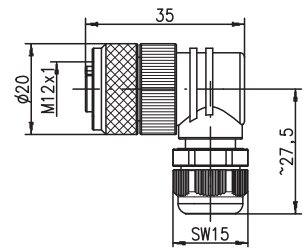

M12 cable plug, axial, 4-/5-pin
KS 095-4A
KS 095-5A

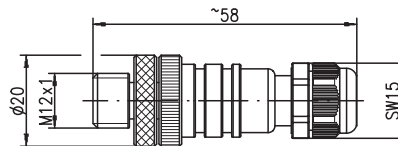

M12 connector, axial, 5-pin
KD 095-5A
KD 095-5A-PG9

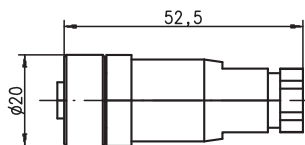

M12 connector, angular, 5-pin
KD 095-5

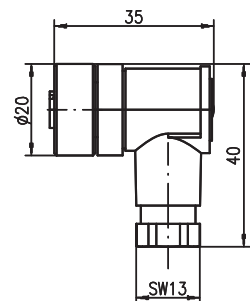

Contact arrangement

M8 connector, 3-pin

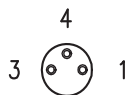

M12 connector, 4-pin



M12 cable plug, 4-pin



M8 connector, 4-pin



M12 connector, 5-pin

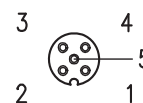

M12 cable plug, 5-pin

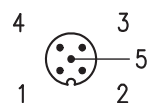

1) only 4-pin M12 connectors and 5-pin M12 plug



We reserve the right to make changes • DS_Accessory/KDKS_en_50112701.fm

Specifications

Electrical data

Operating voltage

M8 connector

≤ 32VAC/DC

M12 connector

4-pin: ≤ 250VAC/DC

Operating current

≤ 4A per contact

5-pin: ≤ 125VAC/DC

Insulation grade

category II acc. to IEC 60664-1

≤ 4A per contact

category II acc. to IEC 60664-1

Mechanical data

Connection type

insulation displacement technology

screw connection

Conductor cross-section

0.14 ... 0.34mm²

0.14 ... 0.75mm²

Sheath diameter

2.5 ... 5.1 mm (black seal)

3.0 ... 6.5mm

PG9: 4.0 ... 8.0mm

Environmental data

Operating temperature range

-25°C ... +85°C

Tables

Diagrams

Order guide

M8 connector

Designation	Part No.	Design	Contacts	Connection type	Other features
D M8A-3P-SK	50104582	axial socket	3	insulation displacement technology	
D M8A-4P-SK	50104583	axial socket	4	insulation displacement technology	

M12 connector

Designation	Part No.	Design	Contacts	Connection type	Other features
KD 095-4A	50031323	axial socket	4	screw connection	cURus
KD 095-4	50031324	angular socket	4	screw connection	cURus
KS 095-4A	50040155	axial plug	4	screw connection	cURus
KD 095-5A	50020501	axial socket	5	screw connection	
KD 095-5	50020502	angular socket	5	screw connection	
KD 095-5A-PG9	50081461	axial socket	5	screw connection	for cables Ø 4 ... 8mm
KS 095-5A	50114223	axial plug	5	screw connection	cURus

Remarks